

CARBON DIOXIDE (CO₂) HEATER INSTRUCTION MANUAL

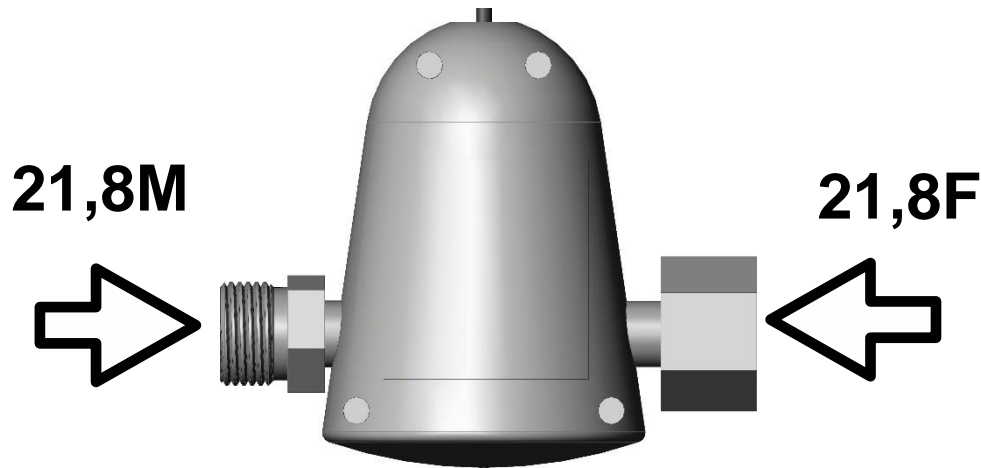

Carbon dioxide (CO₂) heater must be used by regarding the cautions in the instruction

- Carbon dioxide (CO₂) heaters are designed to prevent freeze up and main functioning of cylinder regulators used for carbon dioxide gas.
- The heating element is encapsulated.
- CO₂ heater is saved with steel guard.
- All heat operations at the CO₂ heater to prevent interruption to the flow of gas.

Carbon dioxide (CO₂) heater is designed privately for carbon dioxide gas, don't use your heater with any different types gas . Out firm don't responsible to problems which caused to this kind of use.

- 1 Bottle valve
- 2 Coupling Gasket
- 3 Coupling Nut
- 4 Electric Cable
- 5 Heater Coupling for Connection to Regulator

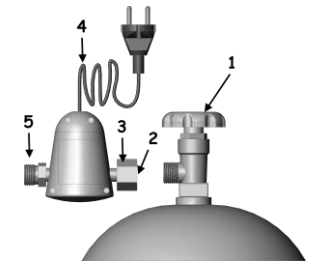

1 CAUTIONS

There must not be done any changes on the Carbon dioxide (CO₂) heater without control and information of our company.

When heater is not used, don't connect the electric outlet with the socket.

Carbon dioxide (CO₂) heaters must be connect to the socket outlet with eating connection.

As the misuse of the Carbon dioxide (CO₂) heaters may cause serious damages, it must be use operated by trained staff.

2 INSTALLATION

Before starting to installation , system harmony must be controlled between gas type and required bottler pressure.

The connection seal 2 on the heater must be changed if it's damaged lost.

Carbon dioxide (CO₂) heaters must be mounted strictly to the pressure reducer.

When heater is not used, don't connect the electric outlet to socket.

Be sure to close bottle valve before installation Carbon dioxide (CO₂) heaters to the pressure reducer.

3 USAGE

Signal lamp is on during the heating operation. When heater reach to sufficient degree (75C) thermostat open the cycle and single lamp turn off.

4 MARKING

CO₂ Heater 
230V|50Hz|75W|75°C

230V —Voltage
50Hz —Frequency
75W —Power
75°C —Degree

5 STORING AND TRANSPORTATION

For avoiding the damage of the production through transportation, keep it in its box.

When there is no usage of Carbon dioxide (CO₂) heaters for a long time, it must be stored in its package or box to protect from dirt, oil or other dirt sources.

Code No.

Type

OUR PRODUCT SHOULD BE USE BY EDUCATED STAFE ABOUT THIS CASE.